



How to bind a GNY Mainnet Wallet to a Binance Smart Chain enabled Metamask wallet

Please note: A GNY Mainnet wallet once bound to one Metamask wallet with its network set to the Binance Smart Chain cannot later be bound to a different Metamask wallet. Similarly a Metamask wallet with its network set to the Binance Smart Chain once bound to a GNY Mainnet wallet cannot later be bound to a different GNY Mainnet wallet.

Please note that the current GNY wallet is optimised for desktop viewing only.

1. Login to your GNY wallet at <https://wallet.gny.io/#/login>
2. Select the BSC Swapgate option on the left hand menu

GNY Web Wallet Latest Block Height:

- Home
- Transfer
- Delegates
- Assets
- Machine Learning
- Ethereum Swapgate
- BSC Swapgate**

Account Info

Address: G Is Locked: No

Balance: 0 GNY

You need 5 GNY to set a second password

3. On the next screen click the "Connect to Metamask" button.

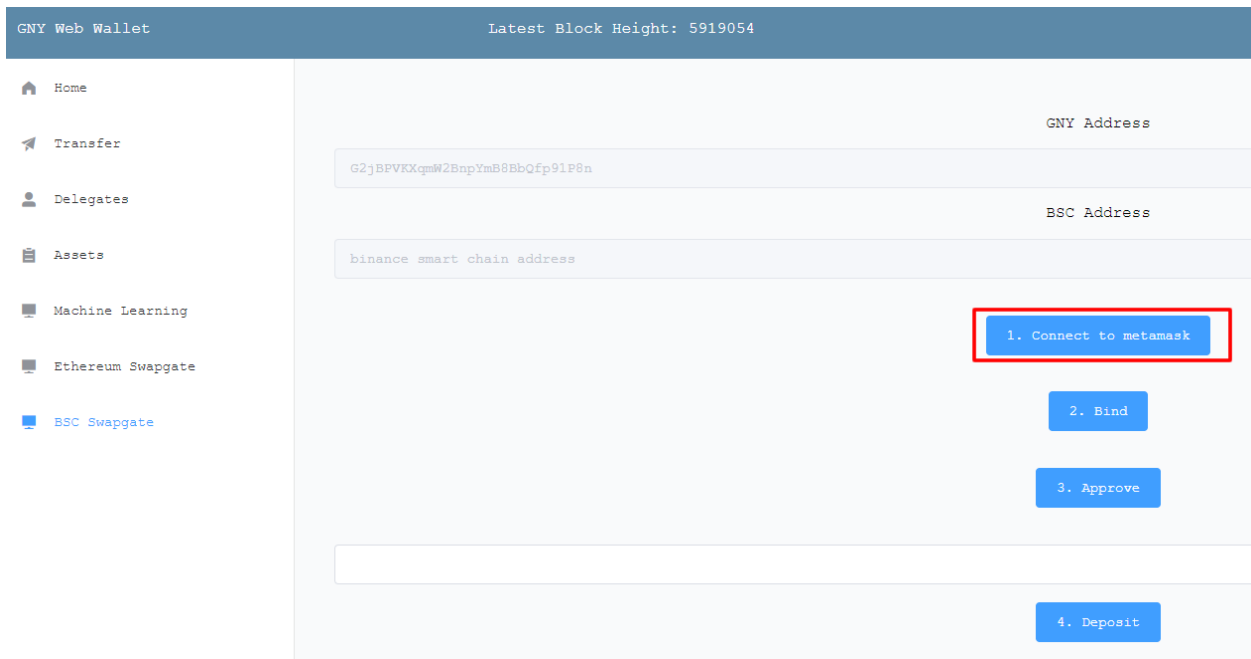

4. Please ensure the status of your Metamask wallet updates to "connected" (green dot visible). Within the network dropdown box ensure that "Binance Smart Chain" is shown as the selected network

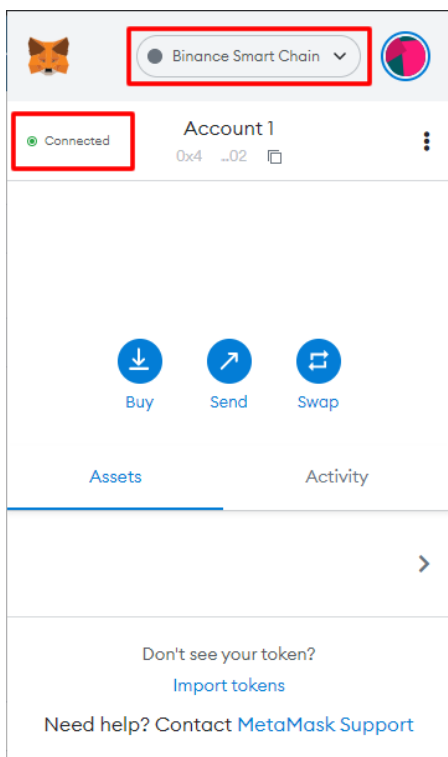

5. Approve the connection between the GNY wallet and Metamask by clicking “Next” on the Metamask notification screen, and then click “Connect” on the follow up screen.

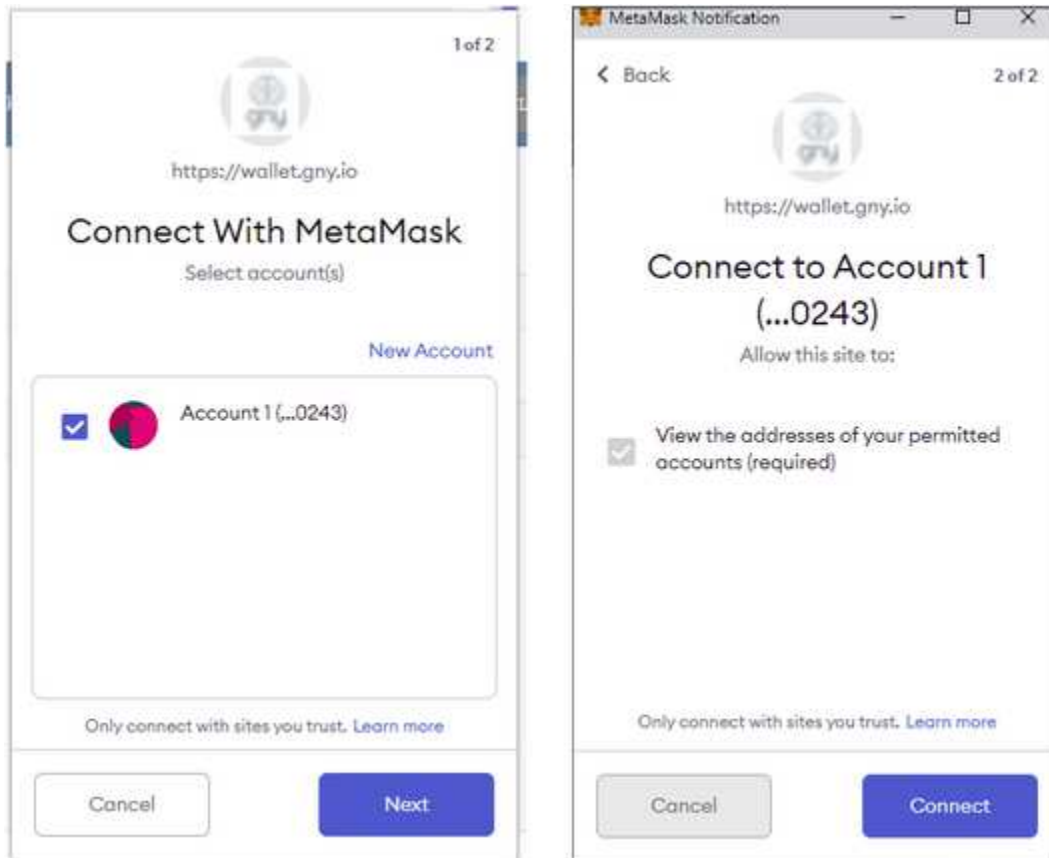

Once the GNY wallet and Metamask wallets are connected your Metamask’s Binance Smart Chain address will populate in the GNY wallet

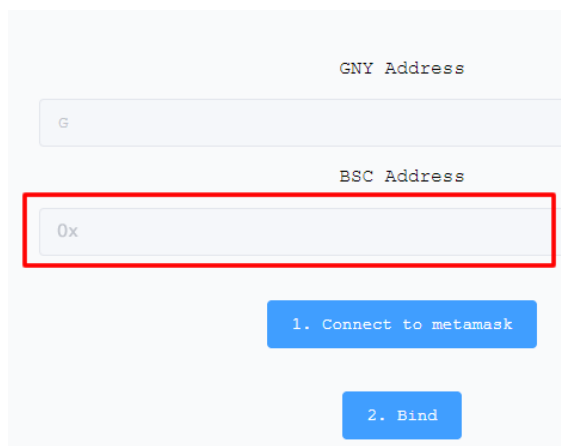

5. Proceed to the next step by clicking the second button labeled “Bind”.

The screenshot displays a web interface for wallet binding. At the top, there is a label "GNY Address" above a text input field containing the character "G". Below this is a label "BSC Address" above a text input field containing "0x". To the right of these fields is a vertical stack of four blue buttons with white text: "1. Connect to metamask", "2. Bind" (which is highlighted with a red rectangular border), "3. Approve", and "4. Deposit". At the bottom of the interface, there is a large empty white rectangular box.

Metamask will ask you to confirm.
Click “Confirm” if the fees are acceptable.

You have now completed the binding of your GNY Mainnet Wallet to a
Binance Smart Chain enabled Metamask wallet.